

Better IT power distribution from the inside out.

PowerTAP MPU is an IT power distribution product used to distribute rack power from a remote power panel (RPP) or panel board. The MPU allows fast deployment and flexibility for periodically changing power at the rack. Combine with PowerLOK rPDUs with over 1600 models from 120V to 415V and to 125A that are built in the USA, TAA compliant and ship in either 3-5 days or 3-5 weeks depending on model.



Provide flexible power options up to 17.2 kW to the rack

PowerTAP Modular Power Unit (MPU) with Power Interface Module (PIM) allows fast power changes at the rack.

- MPU connects directly to a 60A breaker at the panel.
- 9 plug-in-modules: 20A 120V to 60A 208V 3-Phase.
- No more overloading your buss way.
- Quality Hubbell receptacles.
- Made in USA, TAA compliant, UL62368-1, CSA C22.2.



PATENT PENDING

Fast power change at the rack

9 power types, 1 base box

Change power at the rack quickly with multiple PIMs and a single base box.

- 20 to 60 Amps & 120 to 240 Volts.
- Currently up to 17.2kW per feed.
- Contact us for 415V availability.
- Swap out power in under 10 minutes.

120/208V SERIES |

20A 120V (L5-20R)
30A 120V (L5-30R)
20A 208V (L6-20R)
30A 208V (L6-30R)
20A 120/208V 3PH (L21-20R)
30A 120/208V 3PH (L21-30R)
Up to 8.6 kW's

208/240V 3-PHASE SERIES |

30A 208/240V 3PH (L15-30R)
50A 208/240V 3PH (CS8369)
60A 208/240V 3PH (460R9W)
Up to 17.2 kW's

240/415V 3-PHASE SERIES |

20A 240/415V WYE 3PH
30A 240/415V WYE 3PH
60A 240/415V WYE 3PH
Up to 34 kW's

RESERVED

30A 208V

30A 208V

30A 3PH

60A 3PH

60A 3PH

Straight runs from the power panel with flexibility

Build-to-order MPUs with specific cable lengths to meet your site requirements. MC cable sized for 60A 3-Phase to allow fast and flexible power changes at the rack.

PIM replacement

The MPU can be ordered with any PIM which will be shipped attached to the Modular Base Box (MBB). The PIM does not need to be removed during installation or start-up. When power change is required, the PIM is easily and quickly replaced.

- Electrician cuts and ensures no power to MPU from the panel board.
- Back-out (2) PIM screws slightly just to clear mounting flange. 1
- Lift and remove the PIM. 2 3
- Reverse this procedure to install a new PIM.

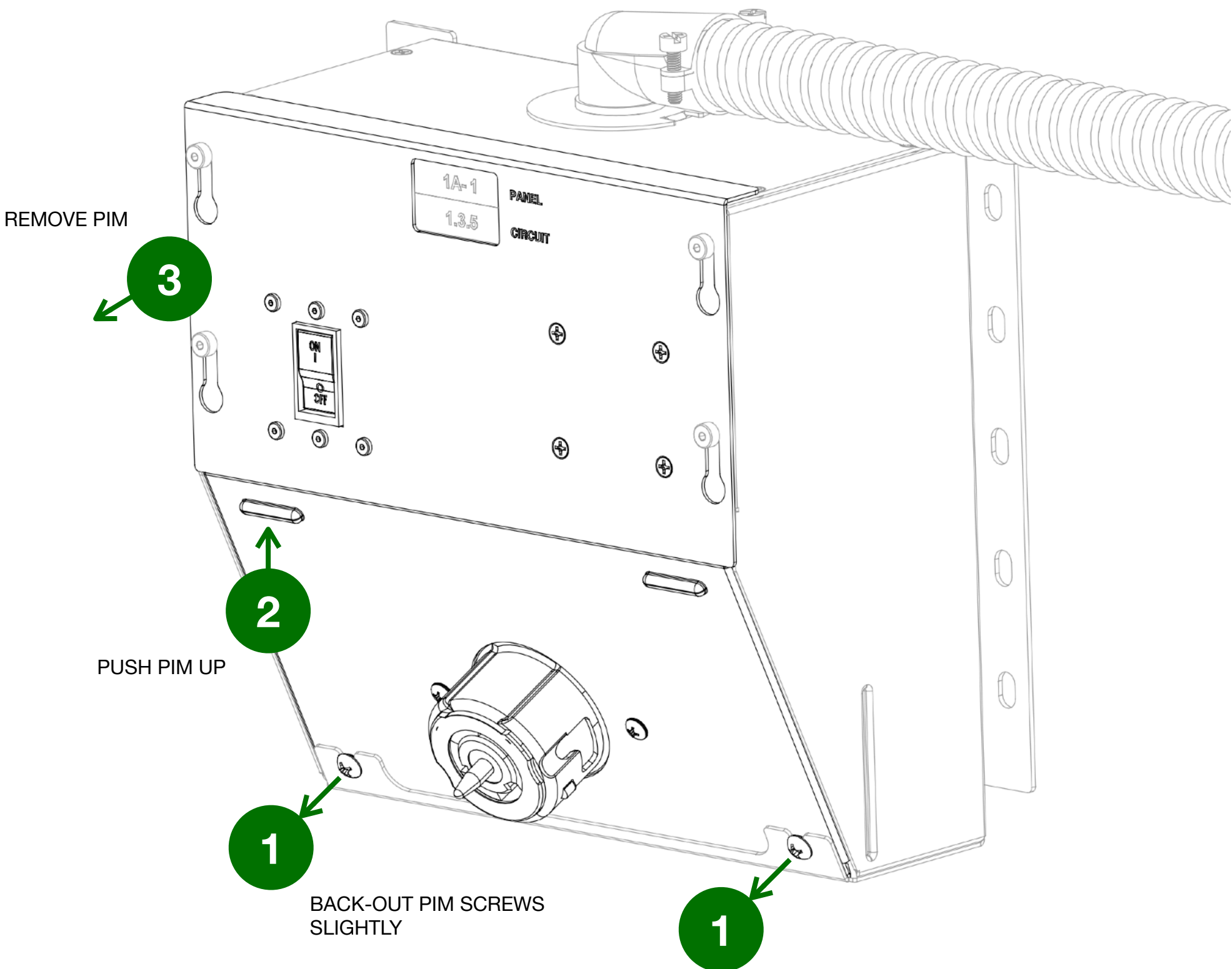

PIM model availability

Order the Modular Base Box (MBB) based on location of rack being powered and the distance from the power panel. MBB can be ordered with a blank panel, if power requirement is not known or with the Power Interface Module (PIM) known need at the time.

- Order MBB with MC cable in 2 FT increments to 68 FT.
- MC cable delivered with 10 FT of jacket removed.
- Prepared for fast connection to the power panel.
- Oversized MC cable loops naturally in tray opposite panel.

MPU MODEL	AMPS	KW	DESCRIPTION
PIM-BLANK-A	0	0	POWER INTERFACE MODULE, BLANK
PIM-L5200-2	20	1.9	POWER INTERFACE MODULE, 2-L5-20R
PIM-L5300-2	30	2.9	POWER INTERFACE MODULE, 2-L5-30R
PIM-L6200-2	20	3.3	POWER INTERFACE MODULE, 2-L6-20R
PIM-L6300-2	30	5.0	POWER INTERFACE MODULE, 2-L6-30R
PIM-L2120-1	20	5.7	POWER INTERFACE MODULE, L21-20R
PIM-L2130-1	30	8.6	POWER INTERFACE MODULE, L21-30R
PIM-L1530-1	30	10.0	POWER INTERFACE MODULE, L15-30R
PIM-C8369-1	50	14.4	POWER INTERFACE MODULE, CS8369C
PIM-460R9-1	60	17.2	POWER INTERFACE MODULE, 460R9W

Flexible Unistrut mounting over rack or under floor

PowerTAP MPU provides 5 locations options for Unistrut fastening and a 180 degree rotatable MC cable box connector to facilitate MC cable routing.

Compact 9" x 5" profile and angled receptacle panel provides mounting flexibility.

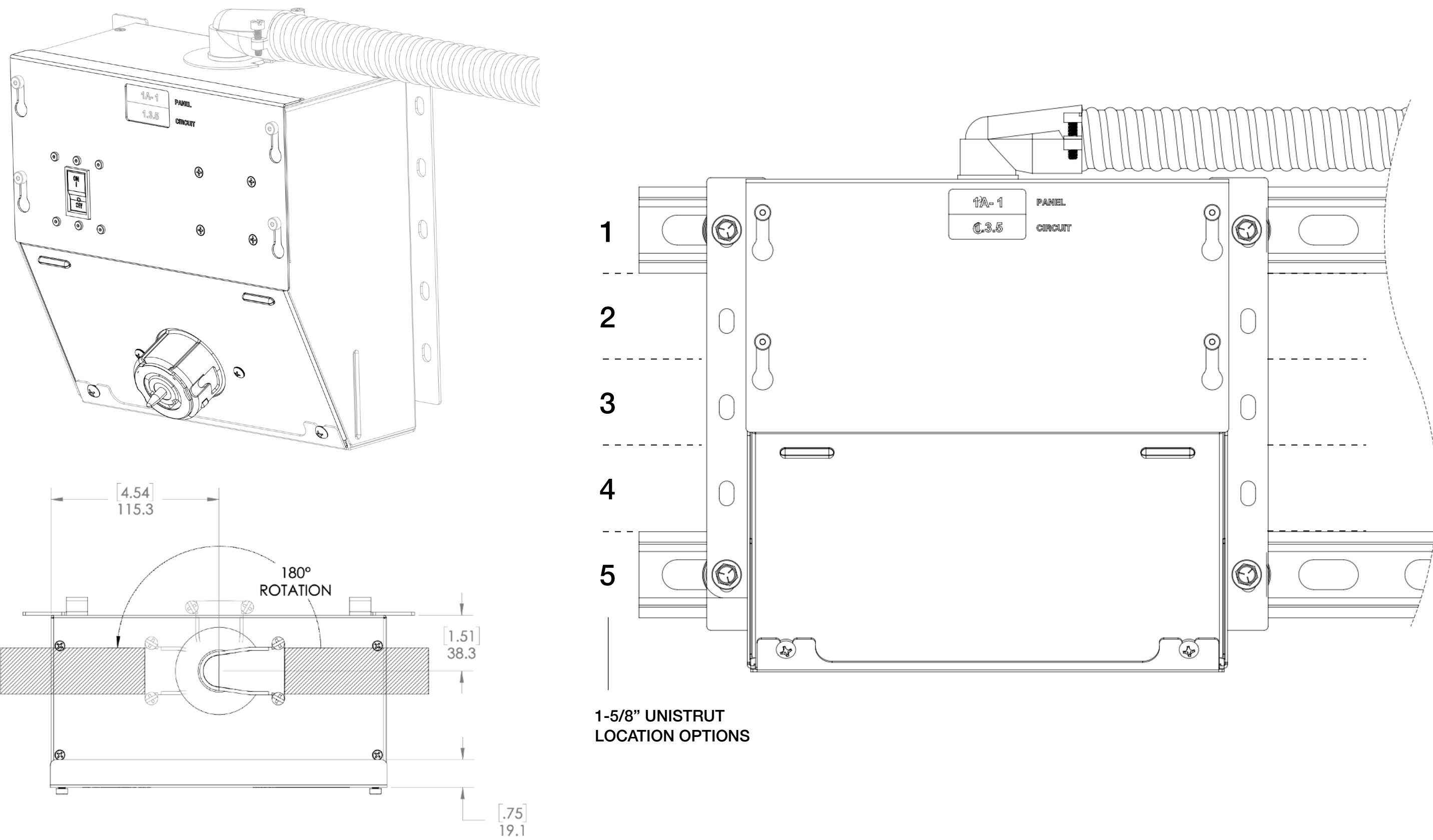

Specifications

POWERTAP SPECIFICATION	
DESCRIPTION	MODULAR POWER UNIT, BASIC, 60A, 120-240V, 5-WIRE MC CABLE, 180 DEGREE ROTATABLE FEED, 10FT JACKET REMOVED, TAA COMPLIANT
POWER	PIM DEPENDENT: 20A 120V 1PH TO 60A 208/240V DELTA 3PH (17.2 kW MAXIMUM CONDITION).
CABLE TYPE	5-WIRE 6AWG MC CABLE, LENGTH PER MODEL SELECTED.
CABLE PREPARATION	ADDITIONAL 10FT OF CABLE ADDED TO THE SELECTED LENGTH HAS JACKET STRIPPED AND WIRES PREPARED FOR BREAKER CONNECTION.
CERTIFICATION	INTERTEK-ETL CERTIFIED TO UL62368-1, CSA CS22.2, RoHS COMPLIANT.
UNIT SIZE	9.1" X 9.3" X 4.9"
MATERIAL	HEAVY DUTY STEEL POWDER COAT PAINT, BLACK.
MOUNTING	.060" FLANGE. USE 1/4-20 UNISTRUT HARDWARE. FLANGE SLOTS ARE ON A 1-5/8" SPACING MATCHING UNI-STRUT WIDTH.
WHERE MADE	USA, TAA COMPLIANT.
WARRANTY	5-YR FROM DATE OF MANUFACTURE, REPAIR OR REPLACE.
OPERATING ENVIRONMENT	0-50C (32-122F), 5-95% RELATIVE HUMIDITY, 0-10,000ft (0-3000 METERS) ELEVATION.
STORAGE ENVIRONMENT	-25-65C (-13-149F), 5-95% REALTIVE HUMIDITY, 0-10,000ft (0-3000 METERS) ELEVATION.