

Better IT power distribution from the inside out.

PowerTAP MPU is an IT power distribution product used to distribute rack power from a remote power panel (RPP) or panel board. The MPU allows fast deployment and flexibility for periodically changing power at the rack. Combine with PowerLOK rPDUs with over 1600 models from 120V to 415V and to 125A that are built in the USA, TAA compliant and ship in either 3-5 days or 3-5 weeks depending on model.



Provide flexible power options up to 17.2 kW to the rack

PowerTAP Modular Power Unit (MPU) with Receptacle Panel (RP) allows fast power changes at the rack.

- MPU connects directly to a 60A breaker at the panel.
- 14 RPs: 20A 120V to 60A 208V or 415V 3-Phase.
- No more overloading your buss way.
- Quality Hubbell receptacles.
- Made in USA, TAA compliant, UL62368-1, CSA C22.2.



PATENT PENDING

Fast power change at the rack

9 power types, 1 base box

Change power at the rack quickly with multiple RP options and a single MPU box.

- 20 to 60 Amps & 120 to 240 Volts.
- Currently up to 17.2kW per feed.
- Contact us for 415V availability.
- Swap out power in under 20 minutes.

120/208V SERIES |

20A 120V (L5-20R)
30A 120V (L5-30R)
20A 208V (L6-20R)
30A 208V (L6-30R)
20A 120/208V 3PH (L21-20R)
30A 120/208V 3PH (L21-30R)
Up to 8.6 kW's

208/240V 3-PHASE SERIES |

30A 208/240V 3PH (L15-30R)
50A 208/240V 3PH (CS8369)
60A 208/240V 3PH (460R9W)
Up to 17.2 kW's

240/415V SERIES |

20A 240V 1PH
30A 240V 1PH
20A 240/415V WYE 3PH
30A 240/415V WYE 3PH
60A 240/415V WYE 3PH
Up to 34 kW's

RESERVED

30A 208V

30A 208V

30A 3PH

60A 3PH

60A 3PH

Straight runs from the power panel with flexibility

Build-to-order MPUs with specific cable lengths to meet your site requirements. MC cable sized for 60A 3-Phase to allow fast and flexible power changes at the rack.

RP replacement

The MPU can be ordered with any RP which will be shipped attached to the MPU. The RP does not need to be removed during installation or start-up. When power change is required, the RP is easily and quickly replaced in less than 20 minutes.

- Electrician cuts and ensures no power to MPU from the panel board.
- Back-out (2) RP screws slightly just to clear mounting flange. 1
- Lift and remove the RP. 2 3
- Remove RP and attach new RP connections.
- Place new RP in position and fasten screws.

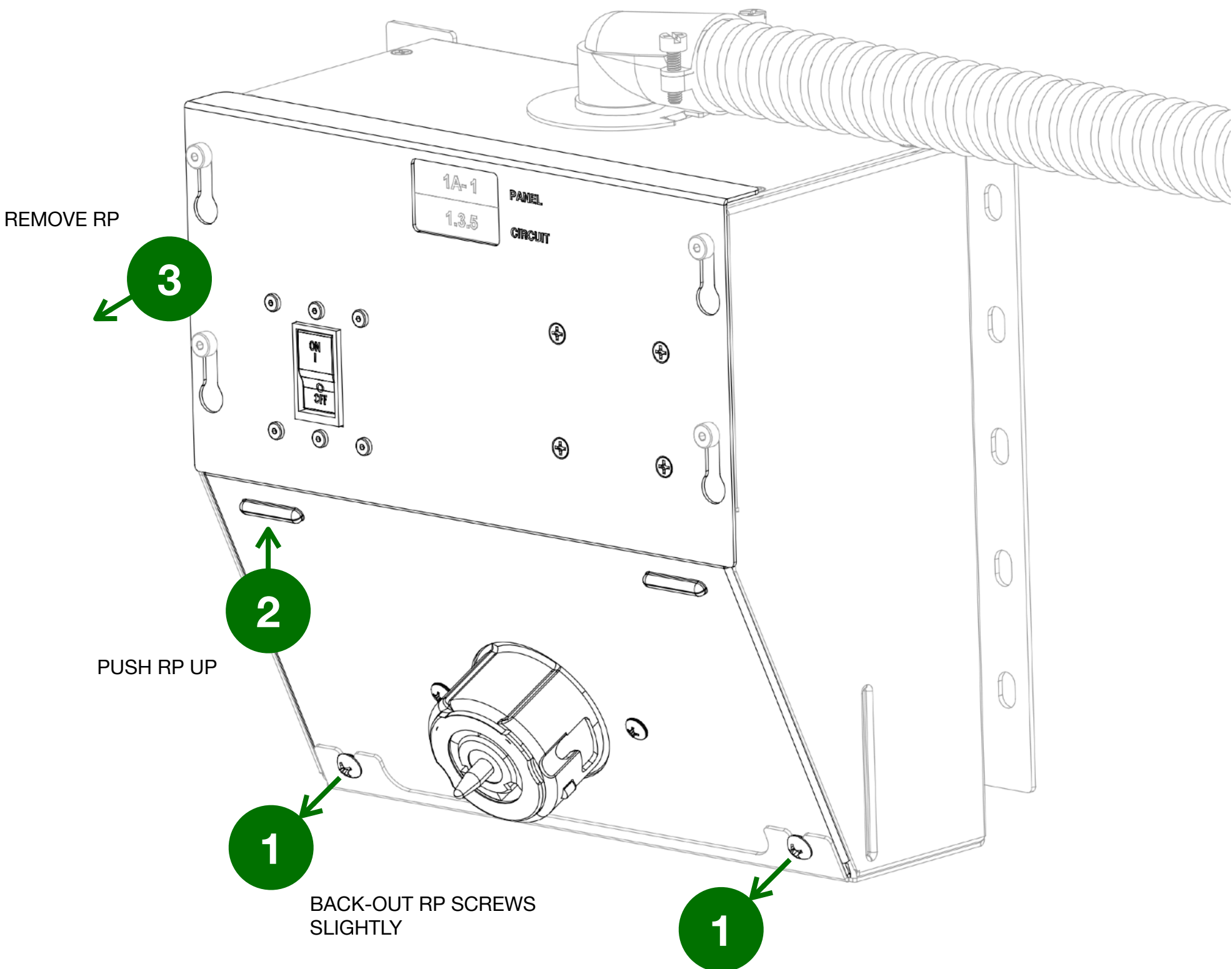

RP model availability

Order the MPU based on location of rack being powered and the distance from the power panel. MPUs are ordered with a blank panel, if power requirement are not known or with a Receptacle Panel (RP) if power type is know at time of ordering.

- Order MPU with MC cable in 2 FT increments to 68 FT.
- MC cable delivered with 10 FT of jacket removed.
- Prepared for fast connection to the power panel.
- Oversized MC cable loops naturally in tray opposite panel.

MPU MODEL	AMPS	KW	DESCRIPTION
RP-BLANK-A	0	0	RECEPTACLE PANEL, BLANK
RP-L5200-2	20	1.9	RECEPTACLE PANEL, 2-L5-20R
RP-L5300-2	30	2.9	RECEPTACLE PANEL, 2-L5-30R
RP-L6200-2	20	3.3	RECEPTACLE PANEL, 2-L6-20R
RP-L6300-2	30	5.0	RECEPTACLE PANEL, 2-L6-30R
RP-L2120-1	20	5.7	RECEPTACLE PANEL, L21-20R
RP-L2130-1	30	8.6	RECEPTACLE PANEL, L21-30R
RP-L1530-1	30	10.0	RECEPTACLE PANEL, L15-30R
RP-C8369-1	50	14.4	RECEPTACLE PANEL, CS8369C
RP-460R9-1	60	17.2	RECEPTACLE PANEL, 460R9W

Flexible Unistrut mounting over rack or under floor

PowerTAP MPU provides 5 locations options for Unistrut fastening and a 180 degree rotatable MC cable box connector to facilitate MC cable routing.

Compact 9" x 5" profile and angled receptacle panel provides mounting flexibility.

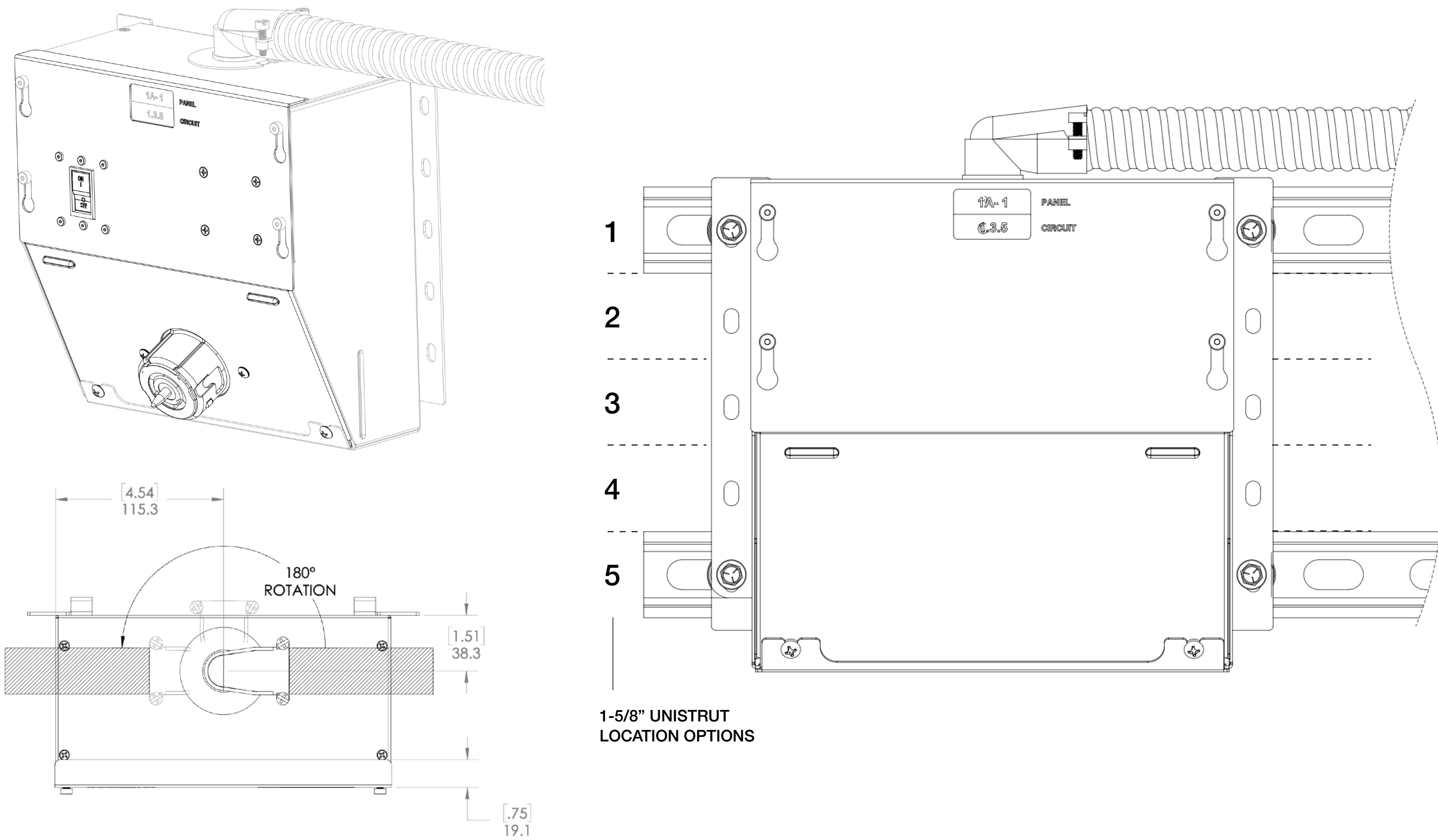

Specifications

POWERTAP SPECIFICATION	
DESCRIPTION	MODULAR POWER UNIT, BASIC, 60A, 120-240V, 5-WIRE MC CABLE, 180 DEGREE ROTATABLE FEED, 10FT JACKET REMOVED, TAA COMPLIANT
POWER	RP DEPENDENT: 20A 120V 1PH TO 60A 208/240V DELTA 3PH (17.2 kW MAXIMUM CONDITION).
CABLE TYPE	5-WIRE 6AWG MC CABLE, LENGTH PER MODEL SELECTED.
CABLE PREPARATION	ADDITIONAL 10FT OF CABLE ADDED TO THE SELECTED LENGTH HAS JACKET STRIPPED AND WIRES PREPARED FOR BREAKER CONNECTION.
CERTIFICATION	INTERTEK-ETL CERTIFIED TO UL62368-1, CSA CS22.2, RoHS COMPLIANT.
UNIT SIZE	9.1" X 9.3" X 4.9"
MATERIAL	HEAVY DUTY STEEL POWDER COAT PAINT, BLACK.
MOUNTING	.060" FLANGE. USE 1/4-20 UNISTRUT HARDWARE. FLANGE SLOTS ARE ON A 1-5/8" SPACING MATCHING UNI-STRUT WIDTH.
WHERE MADE	USA, TAA COMPLIANT.
WARRANTY	5-YR FROM DATE OF MANUFACTURE, REPAIR OR REPLACE.
OPERATING ENVIRONMENT	0-50C (32-122F), 5-95% RELATIVE HUMIDITY, 0-10,000ft (0-3000 METERS) ELEVATION.
STORAGE ENVIRONMENT	-25-65C (-13-149F), 5-95% REALTIVE HUMIDITY, 0-10,000ft (0-3000 METERS) ELEVATION.